

Jul.1.2023 Copyright 2023 HIROSE ELECTRIC CO., LTD. All Rights Reserved.  
 In case of consideration for using Automotive equipment / device which demand high reliability, kindly contact our sales window correspondents.

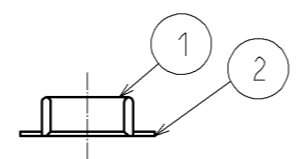

A-A (50:1)

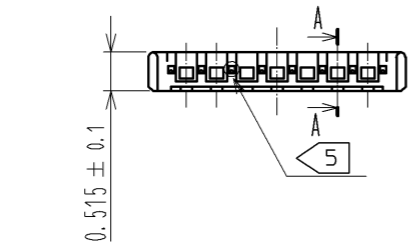
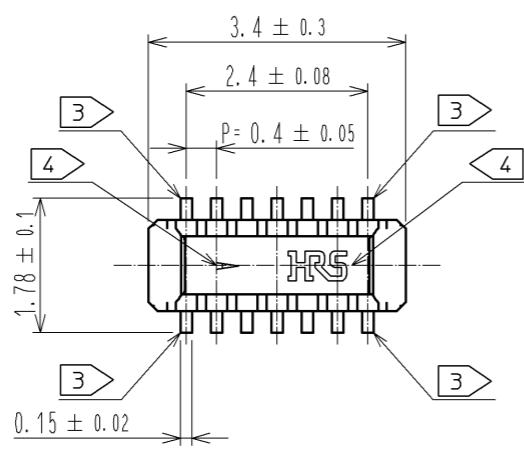
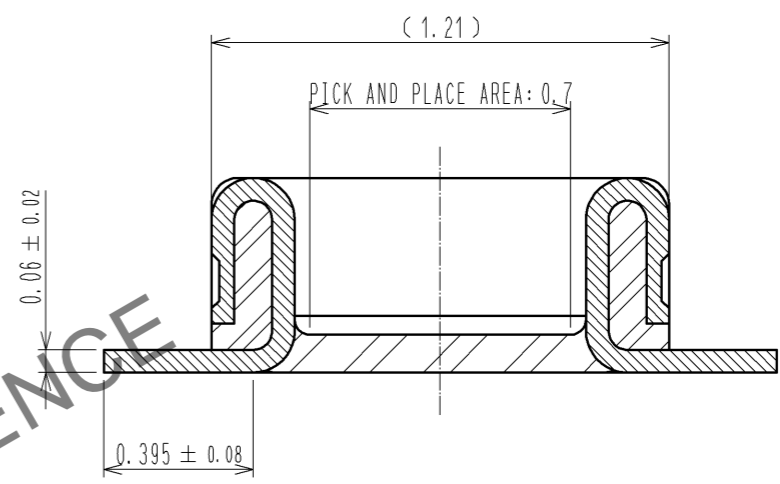

ENGAGEMENT FIGURE (50:1)

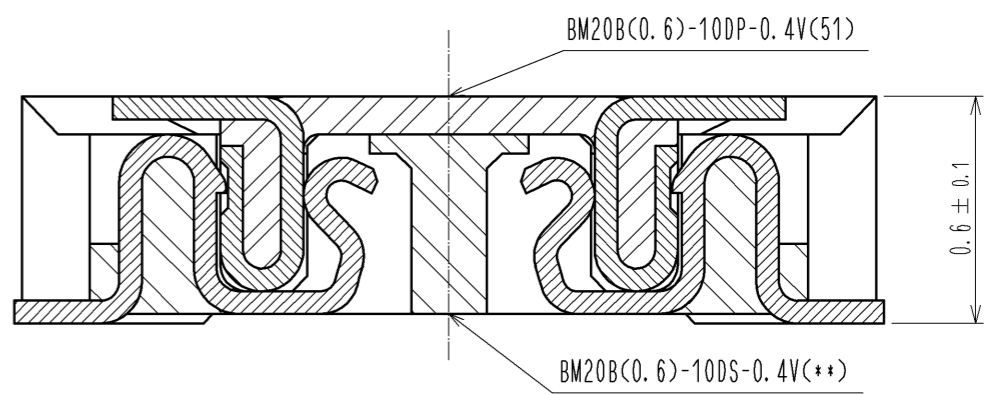

- NOTE 1 . ALL LEAD CO-PLANARITY SHALL BE 0.08mm MAX
- 2 CONTACT PLATING SPECIFICATIONS  
 CONTACT AREA : GOLD 0.05μm MIN  
 SMT LEAD : GOLD 0.05μm MIN  
 UNDER PLATING : NICKEL 1μm MIN  
 ( SURFACE : SEALING )
  - 3 EACH CONTACTS AT 4 CORNERS ARE PROVIDED FOR METAL FITTINGS.
  - 4 HRS MARK AND CAV No. ARE INDICATED IN APPROX POSITION SHOWN.
  - 5 A PART OF THE WALL COULD BE NOTCHED.

| 3                      | PS              | CLEAR (EMBOSSED CARRIER TAPE) | 6          | PS                                       | CLEAR (REINFORCEMENT COLLAR) |
|------------------------|-----------------|-------------------------------|------------|--|------------------------------|
| 2                      | PHOSPHOR BRONZE | 2                             | 5          | PS                                       | BLACK (PLASTIC REEL)         |
| 1                      | LCP             | UL94 V-0, BLACK               | 4          | POLYESTER                                | CLEAR (COVER TAPE)           |
| NO.                    | MATERIAL        | FINISH . REMARKS              | NO.        | MATERIAL                                 | FINISH . REMARKS             |
| UNITS<br>mm            |                 | SCALE<br>10 : 1               | COUNT<br>1 | DESCRIPTION OF REVISIONS<br>DIS-H-008208 |                              |
| DESIGNED<br>KR. AJITO  |                 | CHECKED<br>TS. MIYAZAKI       |            | DATE<br>13. 10. 09                       |                              |
| APPROVED : KH. IKEDA   |                 | 12. 11. 05                    |            | DRAWING NO.<br>EDC3-347087-51            |                              |
| CHECKED : WR. FUKUCHI  |                 | 12. 11. 05                    |            | PART NO.<br>BM20B(0.6)-10DP-0.4V(51)     |                              |
| DESIGNED : RT. SHIMIZU |                 | 12. 11. 05                    |            | CODE NO.<br>CL684-9300-6-51              |                              |
| DRAWN : RT. SHIMIZU    |                 | 12. 11. 05                    |            | 1/3                                      |                              |

Jul.1.2023 Copyright 2023 HIROSE ELECTRIC CO., LTD. All Rights Reserved.  
 In case of consideration for using Automotive equipment / device which demand high reliability, kindly contact our sales window correspondents.

◆ RECOMMENDED PCB LAYOUT

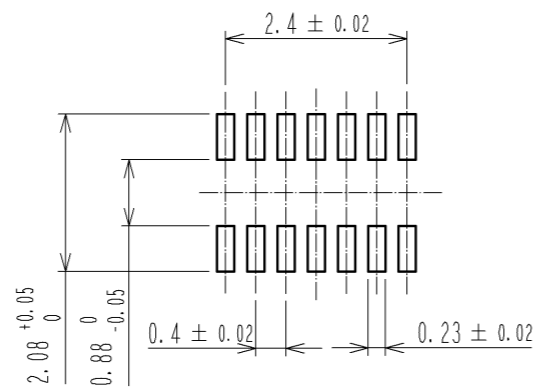

◆ RECOMMENDED METAL MASK DIMENSIONS

METAL MASK THICKNESS :  $100 \mu\text{m}$

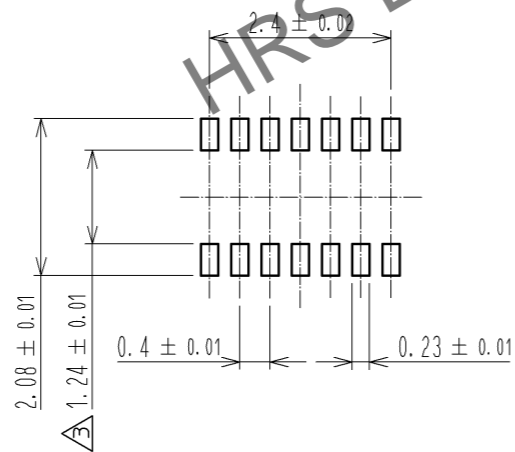

6 RECOMMENDED REFLOW TEMPERATURE PROFILE USING LEAD-FREE SOLDER PASTE.

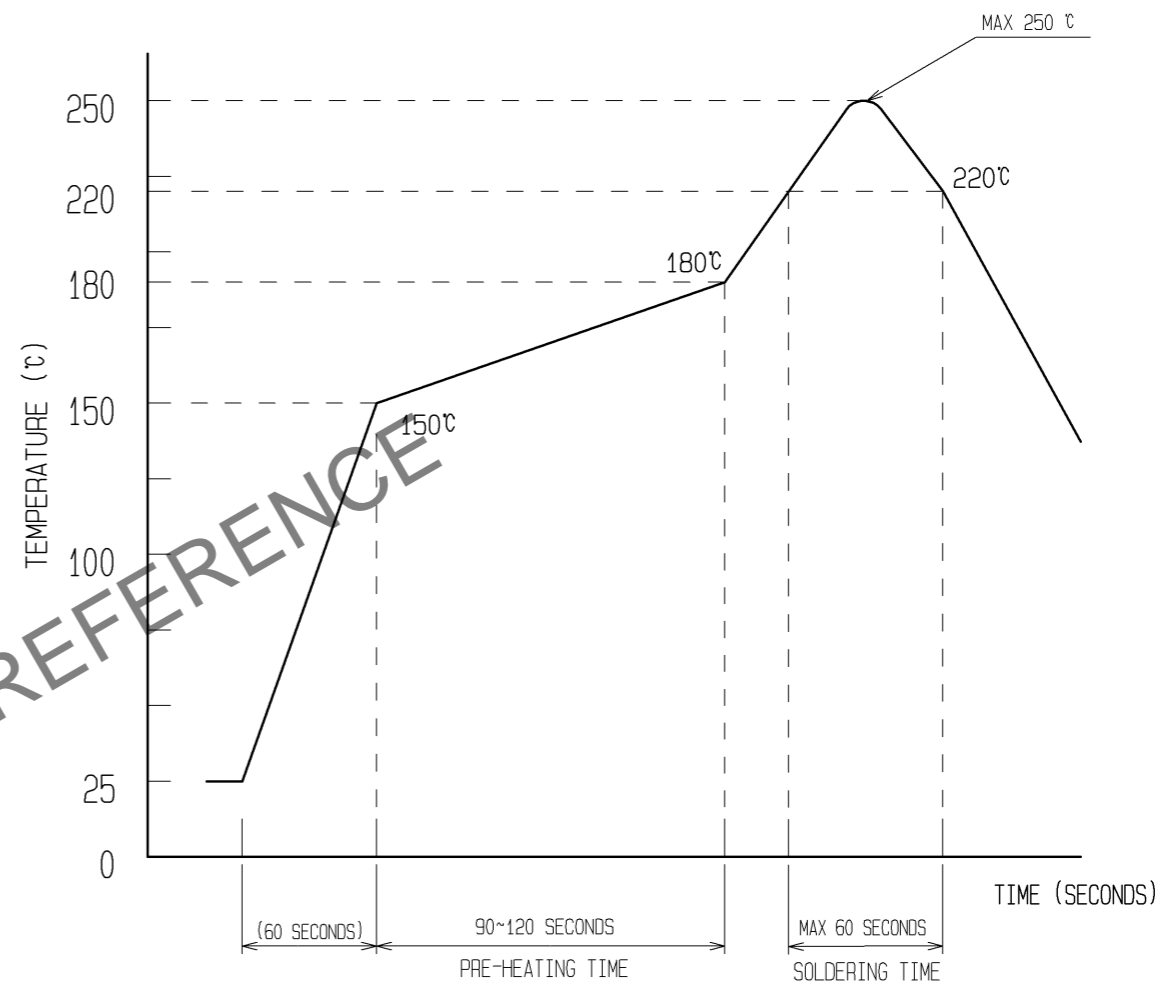

REFLOW METHOD: IR REFLOW  
 NUMBER OF REFLOW CYCLES: 2 CYCLES MAX.  
 1) REFLOW TIME  
 DURATION ABOVE 220°C: 60 SEC MAX.  
 (PEAK TEMPERATURE: 250°C MAX)  
 2) PRE-HEAT TIME  
 PRE-HEAT TEMPERATURE(MIN): 150°C  
 PRE-HEAT TEMPERATURE(MAX): 180°C  
 PRE-HEAT TIME: 90-120 SEC.

6 THIS TEMPERATURE PROFILE IS PER THE CONDITIONS SHOWN ABOVE. ADDITIONAL FACTORS, SUCH AS SOLDER PASTE TYPE, PCB SIZE AND OTHER MOUNTED COMPONENTS COULD AFFECT THE PROFILE. THEREFORE, A THOROUGH EVALUATION OF MOUNTING CONDITION IS REQUIRED PRIOR TO PRODUCTION. TEMPERATURE IS MEASURED AT CONTACT LEAD.

|            |             |                          |
|------------|-------------|--------------------------|
| <b>HRS</b> | DRAWING NO. | EDC3-347087-51           |
|            | PART NO.    | BM20B(0.6)-10DP-0.4V(51) |
|            | CODE NO.    | CL684-9300-6-51          |

Jul.1.2023 Copyright 2023 HIROSE ELECTRIC CO., LTD. All Rights Reserved.  
 In case of consideration for using Automotive equipment / device which demand high reliability, kindly contact our sales window correspondents.

### EMBOSED CARRIER TAPE PACKAGING (5:1)

### STYLE AND DIMENTION OF REEL (FREE)

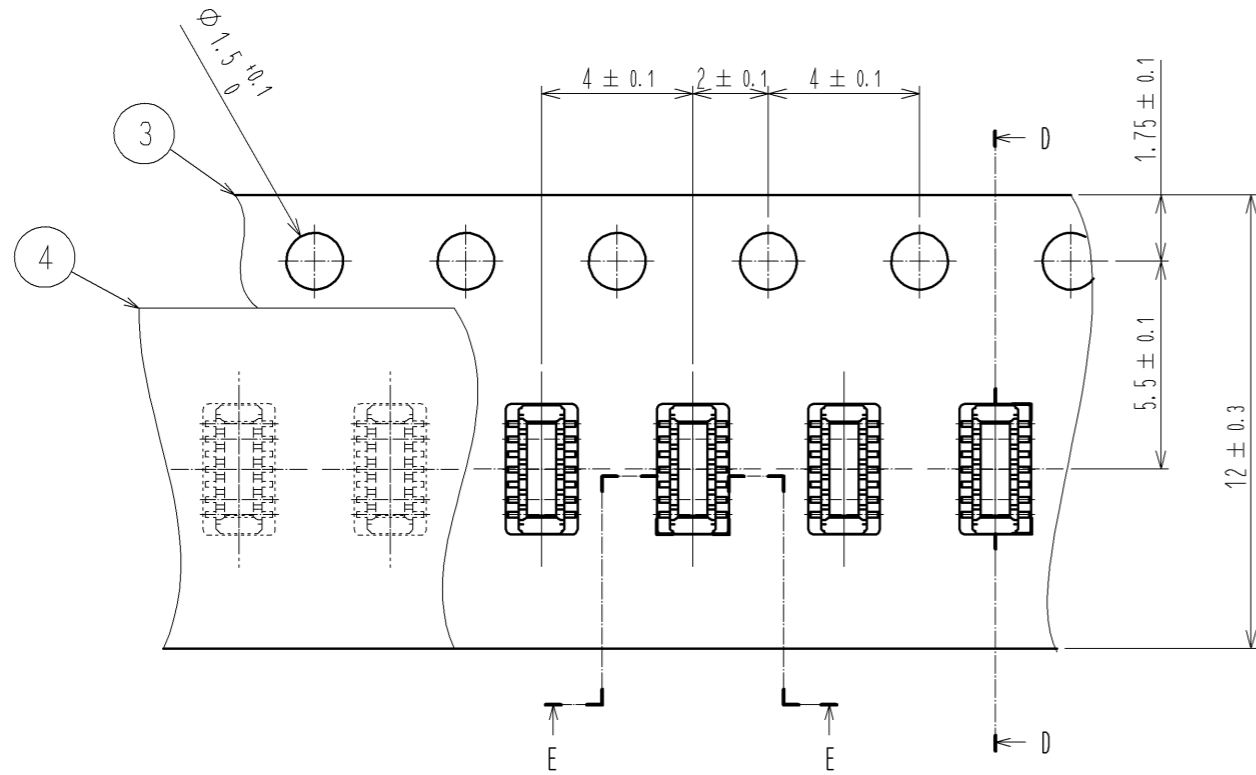

D-D (5:1)

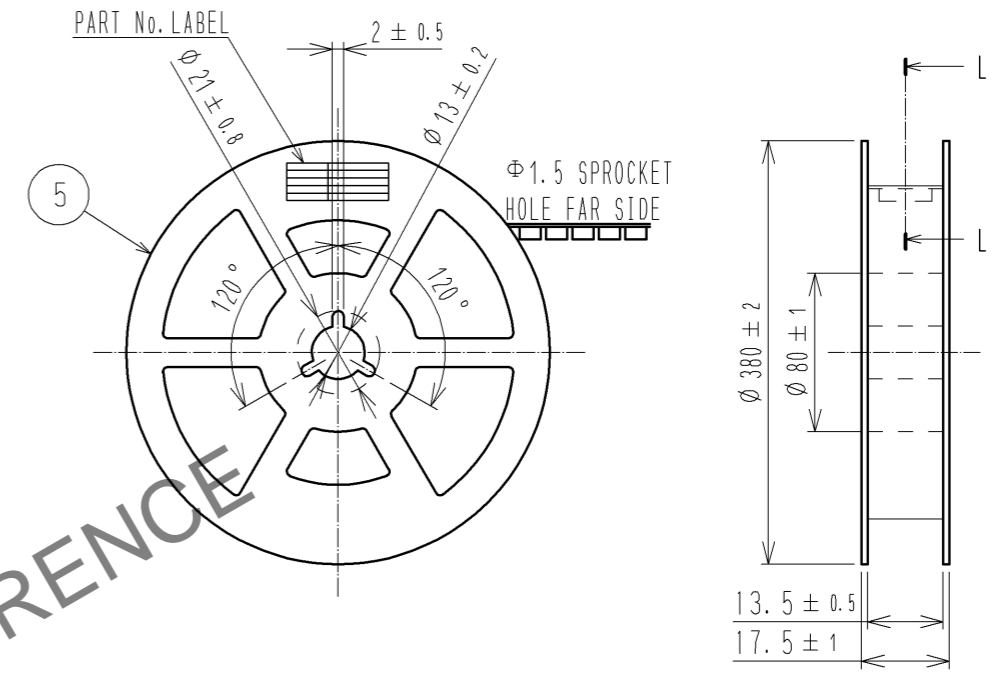
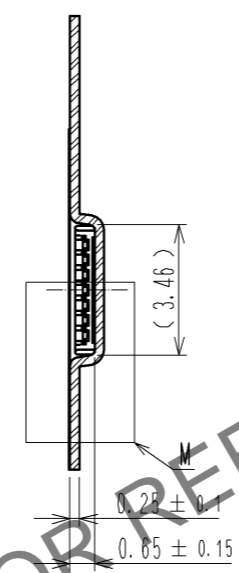

DIRECTION OF UNREELING

E-E (5:1)

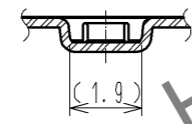

L-L (FREE)

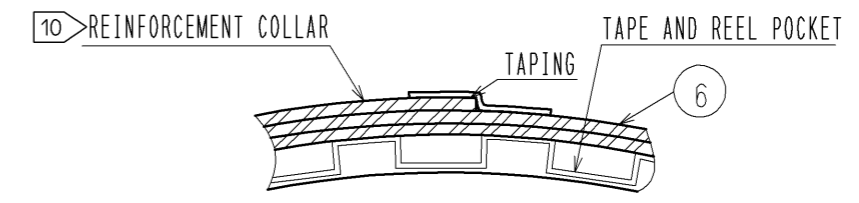

M (10:1)

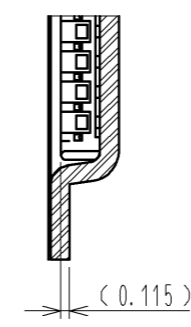

#### DETAIL OF PART No. LABEL

|       |                          |                      |
|-------|--------------------------|----------------------|
| 製造年月日 | ** ** *                  | DATE OF MANUFACTURED |
| 製品コード | CL684-9300-6-51          | CODE No.             |
| 製品名   | BM20B(0.6)-10DP-0.4V(51) | PART No.             |
| 数量    | 8,000                    | QUANTITY             |
| 納入者   | ヒロセ電機(株)                 | SUPPLIER             |

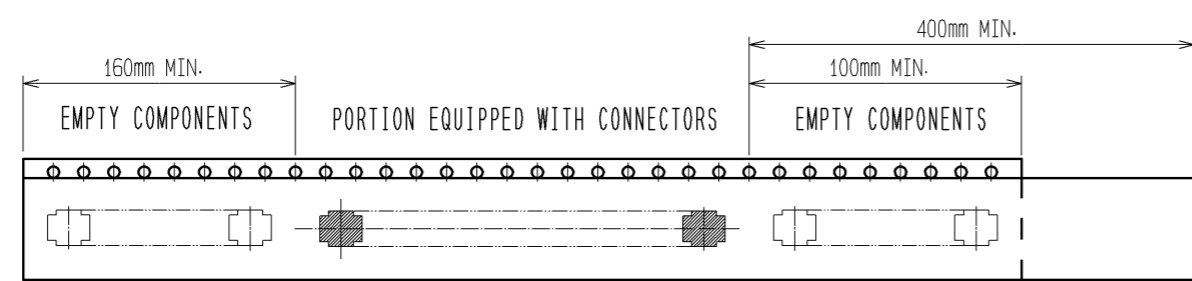

9 TAPING(FREE)

- 7. PER REEL 8000 CONNECTORS.
- 8. THE DIMENTION IN PARENTHESIS ARE FOR REFERENCE.
- 9 REFER TO JIS C 0806(PACKAGING OF COMPONENTS FOR AUTOMATIC HANDLING)
- 10 AFTER PACKAGING, ROLL 2 METERS OF THE REINFORCEMENT COLLAR TO OUTER CIRCUMFERENCE OF TAPE AND REEL POCKET. AND TAPE DOWN AT THE END THE COLLAR.

|            |             |                          |
|------------|-------------|--------------------------|
| <b>HRS</b> | DRAWING NO. | EDC3-347087-51           |
|            | PART NO.    | BM20B(0.6)-10DP-0.4V(51) |
|            | CODE NO.    | CL684-9300-6-51          |
|            |             | 3/3                      |

# Mouser Electronics

Authorized Distributor

Click to View Pricing, Inventory, Delivery & Lifecycle Information:

[Hirose Electric:](#)

[BM20B\(0.6\)-10DP-0.4V\(51\)](#)