

RECEPTACLES

TVP00R/TVPS00R
 CTVP00R/CTVPS00R
 TVP02R/TVPS02R
 CTVP02R/CTVPS02R
 D38999/20 (CONTINUED)

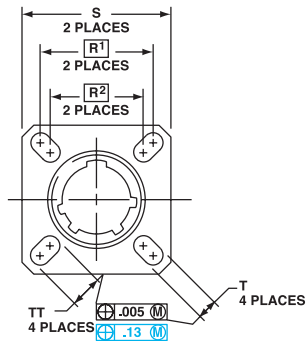

R1	R2	S Max.	T +.008/- .006 (+.200/- .130)	TT +.008/- .006 (+.200/- .130)	V Thread Metric
.719 (18.26)	.594 (15.09)	.948 (24.10)	.128 (3.25)	.216 (5.49)	M12X1-6g
.812 (20.62)	.719 (18.26)	1.043 (26.50)	.128 (3.25)	.194 (4.93)	M15X1-6g
.906 (23.01)	.812 (20.62)	1.137 (28.90)	.128 (3.25)	.194 (4.93)	M18X1-6g
.969 (24.61)	.906 (23.01)	1.232 (31.30)	.128 (3.25)	.173 (4.39)	M22X1-6g
1.062 (26.97)	.969 (24.61)	1.323 (33.70)	.128 (3.25)	.194 (4.93)	M25X1-6g
1.156 (29.36)	1.062 (26.97)	1.449 (36.90)	.128 (3.25)	.194 (4.93)	M28X1-6g
1.250 (31.75)	1.156 (29.36)	1.575 (40.10)	.128 (3.25)	.194 (4.93)	M31X1-6g
1.375 (34.92)	1.250 (31.75)	1.701 (43.30)	.154 (3.91)	.242 (6.15)	M34X1-6g
1.500 (38.10)	1.375 (34.92)	1.823 (46.40)	.154 (3.91)	.242 (6.15)	M37X1-6g

TV07R/TVS07R
 CTV02R/CTVS07R
 D38999/24

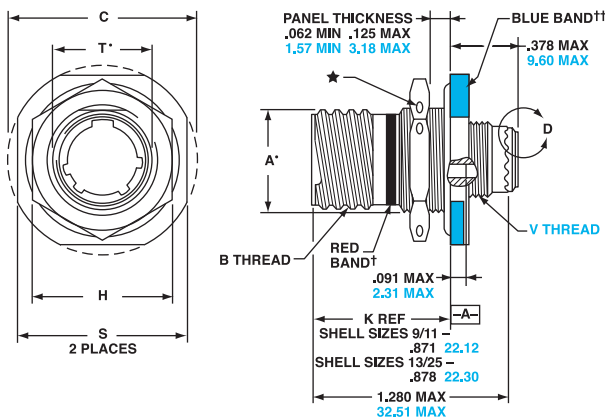

Shell Size		A* +.000/- .010 (+.000/- .250)	B Thread Class 2A 0.1P- 0.3L-TS (Plated)	C Max. Flange Wrench	D1 +.010/- .000 (+.250/- .000)	D2 +.010/- .000 (+.250/- .000)	H Hex +.017/- .016 (+.430/- .410)	S ±.010	T* +.010/- .000 (+.250/- .000)	V Thread Metric
TV07/CTV07	D38999/24									
9	A	0.669 (16.99)	0.6250	1.199 (30.45)	.700 (17.78)	.670 (17.02)	.875 (22.23)	1.062 (26.97)	.697 (17.70)	M12X1-6g
11	B	0.769 (19.53)	0.7500	1.386 (35.20)	.825 (20.96)	.770 (19.59)	1.000 (25.40)	1.250 (31.75)	.822 (20.88)	M15X1-6g
13	C	0.955 (24.26)	0.8750	1.511 (38.38)	1.010 (25.65)	.955 (24.26)	1.188 (30.18)	1.375 (34.93)	1.007 (25.58)	M18X1-6g
15	D	1.084 (27.53)	1.0000	1.636 (41.55)	1.135 (28.83)	1.085 (27.56)	1.312 (33.32)	1.500 (38.10)	1.134 (28.80)	M22X1-6g
17	E	1.208 (30.68)	1.1875	1.761 (44.73)	1.260 (32.01)	1.210 (30.73)	1.438 (36.53)	1.625 (41.28)	1.259 (31.98)	M25X1-6g
19	F	1.333 (33.86)	1.2500	1.949 (49.50)	1.385 (35.18)	1.335 (33.91)	1.562 (39.67)	1.812 (46.02)	1.384 (35.15)	M28X1-6g
21	G	1.459 (37.06)	1.3750	2.073 (52.65)	1.510 (38.35)	1.460 (37.08)	1.688 (42.80)	1.938 (49.23)	1.507 (38.28)	M31X1-6g
23	H	1.575 (40.01)	1.5000	2.199 (55.85)	1.635 (41.53)	1.585 (40.26)	1.812 (46.02)	2.062 (52.37)	1.634 (41.50)	M34X1-6g
25	J	1.709 (43.41)	1.6250	2.323 (59.00)	1.760 (44.70)	1.710 (43.43)	2.000 (50.80)	2.188 (55.58)	1.759 (44.68)	M37X1-6G

All dimensions in inches (millimeters in parenthesis)